



\$12/ft<sup>2</sup>

# 168 TIFFIN STREET, BARRIE

8,000 ft<sup>2</sup> Industrial Property for Lease in Central Barrie

**JOANNA  
SMITH**

**Joanna Smith**  
Sales Representative  
705 229 8711  
js@phillipmoore.ca

**Sutton**  
Independent Member Broker

**Sutton Group Incentive Realty**  
241 Minet's Point Road  
Barrie, ON L4N 4C4  
705 739 1300

Price	\$12/ft <sup>2</sup>
Area	8,000 ft <sup>2</sup>
Lease Type	Gross Lease
Property Type	Industrial
Taxes	\$3.50/ft <sup>2</sup>
MLS#	S6715330
Lease Term	60/120 Months
Availability	Immediate
Zoning	GI/ General Industrial
Ceiling Height	16'
Land Size	300×500'
Utilities	Municipal

# PROPERTY OVERVIEW

**JOANNA  
SMITH**

**Joanna Smith**  
Sales Representative  
705 229 8711  
js@phillipmoore.ca

**Sutton**  
Independent Member Broker

**Sutton Group Incentive Realty**  
241 Minet's Point Road  
Barrie, ON L4N 4C4  
705 739 1300



# LOCATION PHOTOGRAPHY

**JOANNA  
SMITH**

**Joanna Smith**  
Sales Representative  
705 229 8711  
js@phillipmoore.ca

**Sutton**  
Independent Member Broker

**Sutton Group Incentive Realty**  
241 Minet's Point Road  
Barrie, ON L4N 4C4  
705 739 1300

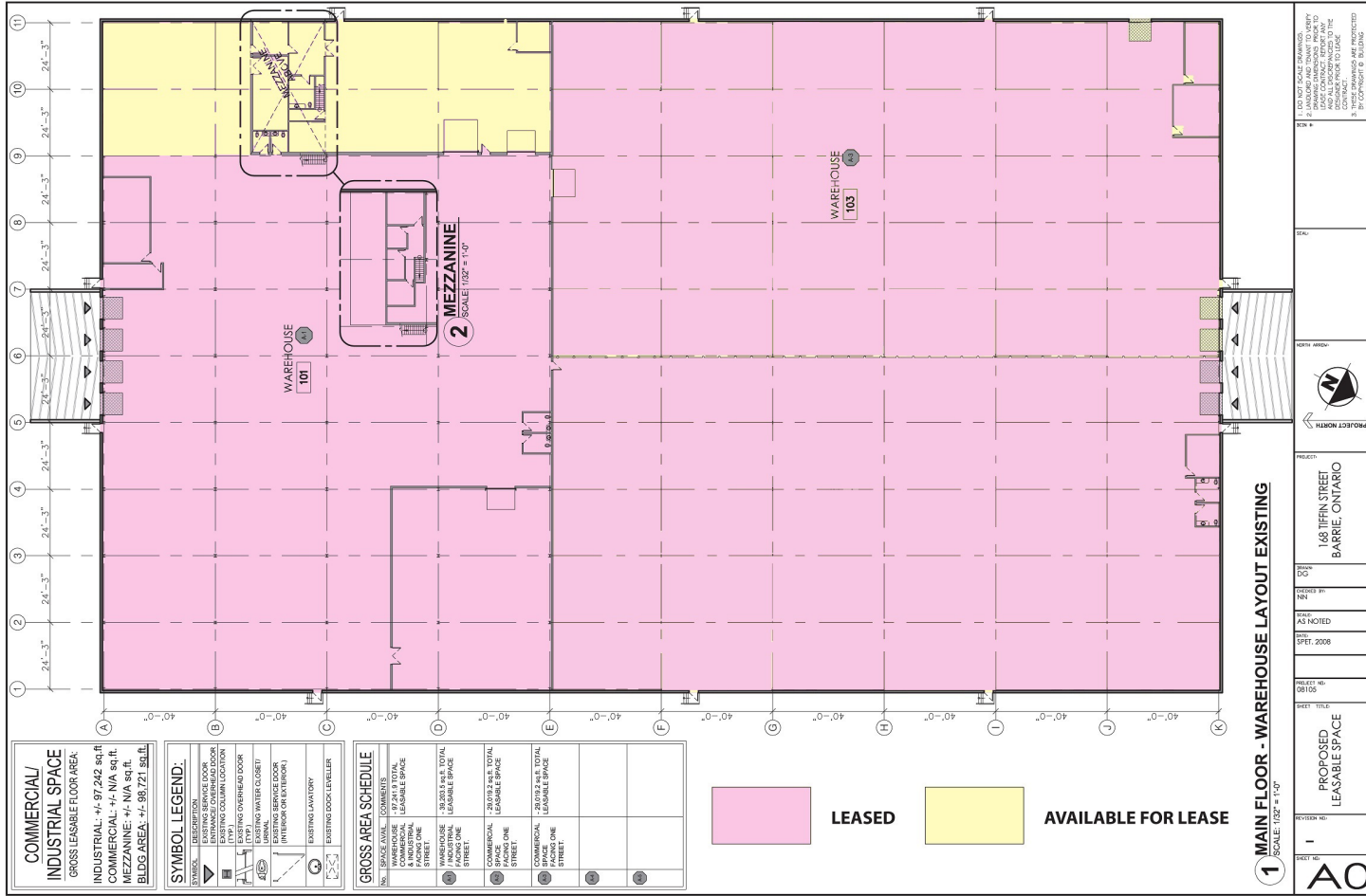

# FLOOR PLAN

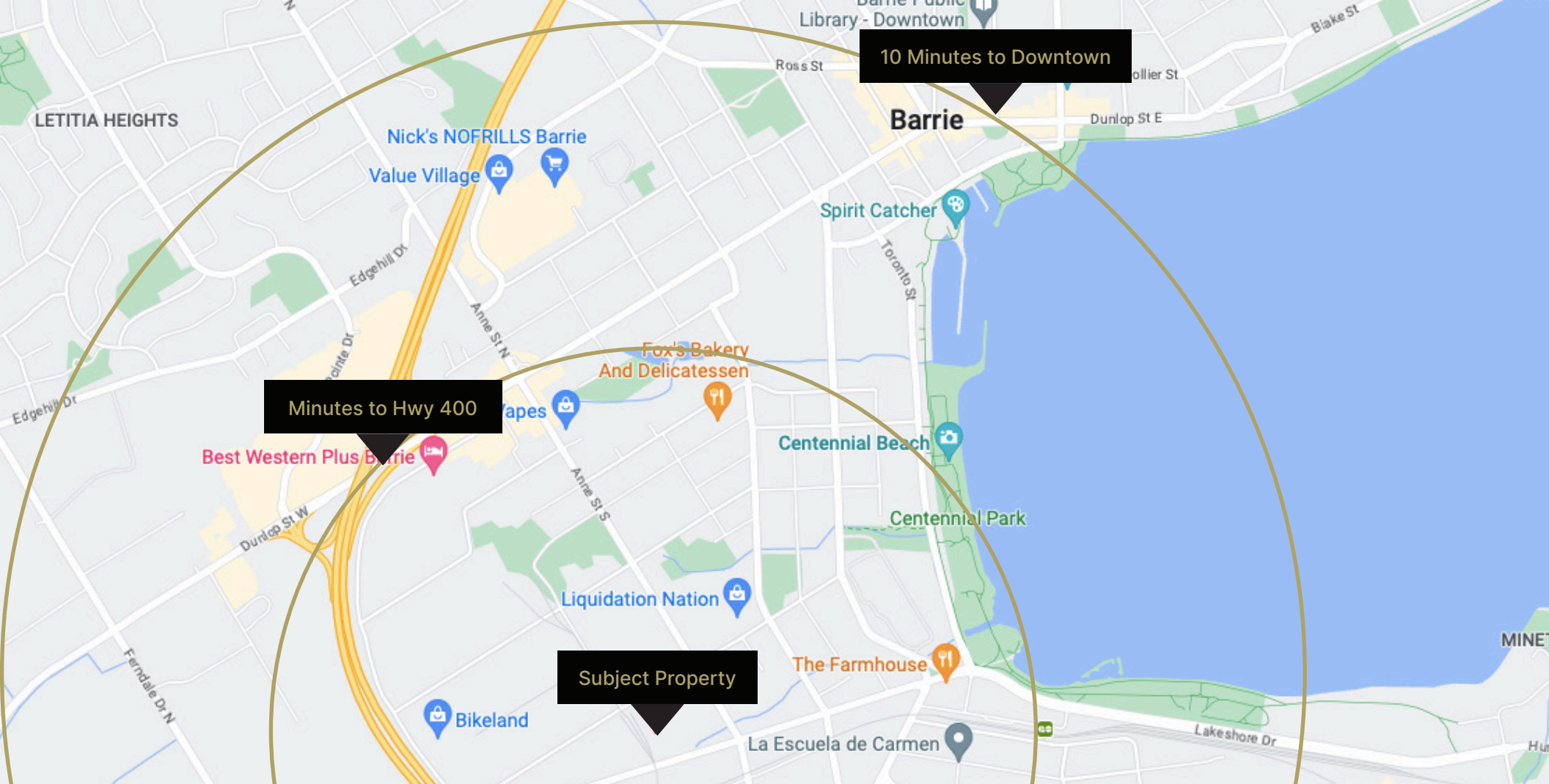

# LOCATED IN SOUTH BARRIE MINUTES FROM HWY 400 10 MINUTES FROM DOWNTOWN

**JOANNA  
SMITH**

**Joanna Smith**  
Sales Representative  
705 229 8711  
js@phillipmoore.ca

**Sutton**  
Independent Member Broker

**Sutton Group Incentive Realty**  
241 Minet's Point Road  
Barrie, ON L4N 4C4  
705 739 1300